

# SPECIFICATION FOR APPROVAL

59 1\*1port with transformer and  
EMI, LED, 1000BT, Before 3.18

PRODUCT NAME : \_\_\_\_\_  
PRODUCT NO : \_\_\_\_\_ KW-60002-1

CUSTOMER NO : \_\_\_\_\_

REV : \_\_\_\_\_ DATE : \_\_\_\_\_

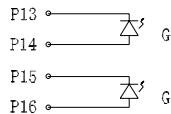
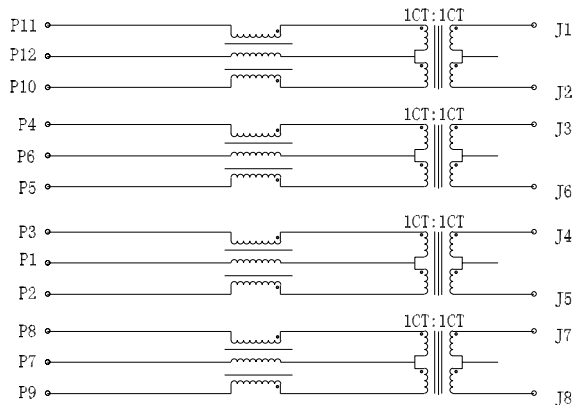
## ELECTRICAL SPECIFICATIONS:

1.0 TURN RATIO:(P11~P10):(J1~J2)  
 (P4~P5):(J3~J6)  
 (P3~P2):(J4~J5)  
 (P8~P9):(J7~J8)

:1:1±3%  
 :1:1±3%  
 :1:1±3%  
 :1:1±3%

SIZE	DRAWING NO:	REV
A	KW-60002-1	01
SCALE		SHEET:
N/A		2 OF 7

2.0 INDUCTANCE: (P11~P10) 350uH MIN @0.1V,100KHZ,8mA DC BIAS  
(P4~P5) 350uH MIN @0.1V,100KHZ,8mA DC BIAS  
(P3~P2) 350uH MIN @0.1V,100KHZ,8mA DC BIAS  
(P8~P9) 350uH MIN @0.1V,100KHZ,8mA DC BIAS

3.0 LEAKAGE INDUCTANCE: P11~P10(WITH J1 AND J2 SHORT) :0.3uH MAX @1MHZ  
P4~P5(WITH J3 AND J6 SHORT) :0.3uH MAX @1MHZ  
P3~P2(WITH J4 AND J5 SHORT) :0.3uH MAX @1MHZ  
P8~P9(WITH J7 AND J8 SHORT) :0.3uH MAX @1MHZ

4.0 INTERWINDING CAPACITANCE: (P11~P10):(J1~J2) :35pF MAX @ 1MHZ  
(P4~P5):(J3~J6) :35pF MAX @ 1MHZ  
(P3~P2):(J4~J5) :35pF MAX @ 1MHZ  
(P8~P9):(J7~J8) :35pF MAX @ 1MHZ

5.0 DC RESISTANCE:(J1~J2):(J3~J6):(J4~J5):(J7~J8) :1.2 OHMS MAX

6.0 RETURN LOSS: 1MHZ TO 30MHZ : -19dB MIN  
30MHZ TO 60MHZ : -13dB MIN  
60MHZ TO 80MHZ : -12dB MIN  
80MHZ TO 100MHZ : -10dB MIN

7.0 DIELECTRIC WITHSTAND: (P11~P10):(J1~J2) :1500VAC  
(P4~P5):(J3~J6) :1500VAC  
(P3~P2):(J4~J5) :1500VAC  
(P8~P9):(J7~J8) :1500VAC

8.0 INSERTION LOSS: RS=RL=100OHM 100KHZ TO 80MHZ : -1.1dB MIN

9.0 RISE TIME : RS=1000HMSAND RL=1000HMS :3.0nS MAX  
OUTPUT VOLTAGE=1V PEAK :3.0nS MAX  
PULSE WIDTH=112nS

10.0 CROSS TALK: 1MHZ TO 100MHZ :-[33-20LOG(F/50MHZ)] MIN

11.0 COMMON TO COMMON MODE ATTENUATION: 30MHZ TO 100MHZ :35dB TYP

SIZE A	DRAWING NO: KW-60002-1	REV 01
SCALE N/A		SHEET: 3 OF 7

# MECHANIC SPECIFICATIONS:

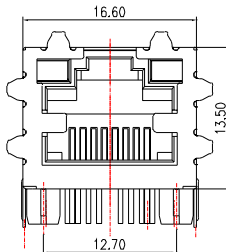
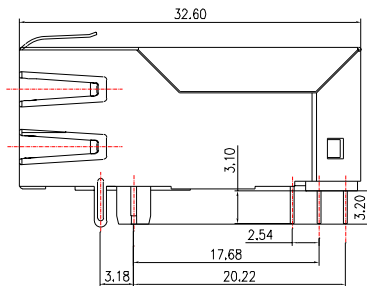
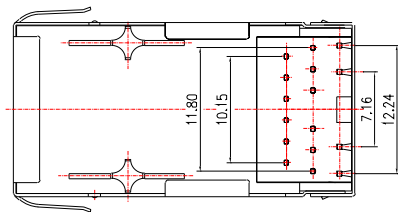

## NOTES:

1. CONNECTOR MATERIAL:
- HOUSING: THERMOPLASTIC UL94 V-0
- CONTACT/SHIELD: COOPER ALLOY
- SHIELD PLATING: NICKEL OR TIN
- CONTACT PLATING: SELECTIVE GOLD,
 

50 MICRO-INCHS MIN	<input type="checkbox"/>
30 MICRO-INCHS MIN	<input type="checkbox"/>
15 MICRO-INCHS MIN	<input type="checkbox"/>
6 MICRO-INCHS MIN	<input type="checkbox"/>
3 MICRO-INCHS MIN	<input type="checkbox"/>
- IN CONTACT AREA

2. PIN NOT ELECTRICALLY CONNECTED MAYBE OMITTED SEE ELECTRICAL DRAWING FOR OMITTED PINS
3. TOLERANCES COMPLY WITH P. C. C DIMENSION REQUIREMENTS
4. WAVE SOLDER COMPATIBLE-PREHEAT 125 C DEGREE/90SECS
5. ALL TOLERANCES NOT OTHERWISE SPECIFIED TO BE  $\pm 0.1\text{mm}$ .

SIZE A	DRAWING NO. <b>KW-60002-1</b>	REV 01
SCALE N/A		SHEET 4 OF 7

# MECHANIC SPECIFICATIONS:

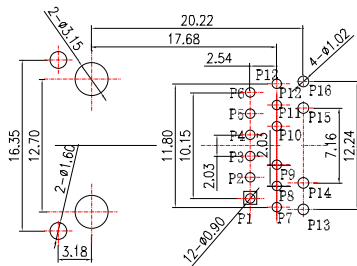

P.C.B RECOMMENDED HOLE LAYOUT SEEN FROM COMPONENT SIDE.

ALL CENTERLINE DIMENSIONS ARE BASIC

LED SPECIFICATION			
STANDARD LED	WAVELENGTH	Forward V(max)	TYP
GREEN	565nm	2.4V	2.2V

\*WITH A FORWARD CURRENT OF 20mA

SIZE A	DRAWING NO. <b>KW-60002-1</b>	REV 01
SCALE N/A		SHEET 5 OF 7

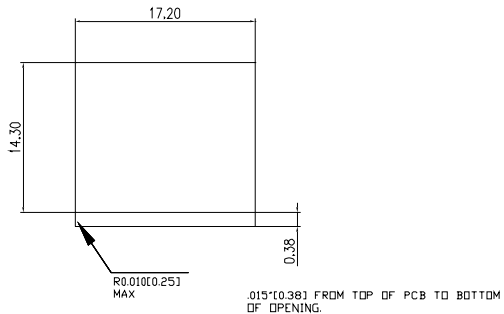

1.SUGGESTED PANEL OPENING(N.T.S)

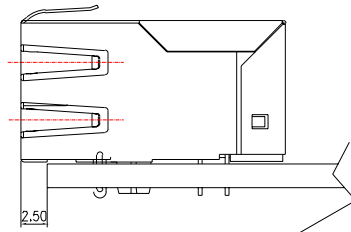

1.THE SUGGESTED PANEL OPENING IS INTENDED  
TO GIVE THE USER THE ABILITY TO HAVE  
REASONABLE JACK/PANEL CLEARANCES CAPABILITY.  
2.ALL TOLERANCES NOT OTHERWISE SPECIFIED  
TO BE ±0.005 INCH(0.13)

SIZE A	DRAWING NO. KW-60002-1	REV 01
SCALE N/A		SHEET 6 OF 7